Exhibitors & Sponsors Prospectus



Omni Shoreham Hotel • September 12-15, 2010

Celebrating 25 Years of Helping Communities
Address Critical Water Supply Issues





25th Annual WaterReuse Symposium

Do not miss the opportunity to target the more than 700 leaders from the water reuse and desalination industry expected to attend the 25th Annual WaterReuse Symposium in Washington, DC. Top professionals from virtually every state and a number of foreign countries — including numerous general managers of water and wastewater utilities — will attend this Symposium. Presented by the WaterReuse Association and cosponsored by the American Water Works Association and the Water Environment Federation, the annual WaterReuse Symposium is the world's preeminent conference devoted to water reuse and desalination.

The WaterReuse Association is a nonprofit organization whose mission is to advance the beneficial and efficient use of water resources through education, sound science, and technology using reclamation, recycling, reuse, and desalination for the benefit of our members, the public, and the environment. Across the United States and the world, communities face water supply challenges due to increasing demand, drought, depletion and contamination of groundwater, and dependence on single sources of supply. WaterReuse addresses these challenges by working with local agencies to implement water reuse and desalination projects that resolve water resource issues and create value for communities.

The 25th Annual WaterReuse Symposium will feature more than 100 technical presentations, pre-conference workshops, poster presentations, technical tours, an international legislative and water policy plenary session, receptions, an awards luncheon, and the ever-popular exhibition component.

Who Will Attend

- Academic Institutions
- Advocacy Groups
- Consulting Engineering Firms
- Desalination Industry
- Environmental Organizations
- Government Officials
- Manufacturers
- Regulators
- Suppliers
- Water and Wastewater Agencies
- Water Reuse Industry

Core Topic Areas

- Advanced Disinfection Technologies
- Agricultural Reuse
- Alternative Drivers of Water Reuse
- Concentrate/Brine Management and Disposal
- Conveyance, Distribution, and Storage System Design and Operation – including cross-connection control
- Credit Trading – inter- and intra-basin issues
- Desalination Case Studies – groundwater and seawater
- Energy-Water Nexus – energy impacts, climate change, drought planning and management
- Environmental Enhancement Reuse, including Wetlands
- Environmental Impacts – desalination and reuse
- Financing, Pricing, Rates and Economics – desalination and reuse
- Green Building, Green Thinking and Reuse Applications
- Ground Water Issues and Concepts – aquifer storage and recovery, recharge, and soil aquifer treatment
- Health Effects and Risk Assessment
- Industrial Reuse
- Innovative Reuse Applications
- Membranes and MBR
- Microconstituents (e.g., pharmaceuticals, personal care products, trace organic compounds)
- Operations/Maintenance and Operator Issues
- Planning for Water Reuse and Desalination
- Potable Reuse
- Public Acceptance/Perception
- Public Education and Outreach
- Regulatory, Institutional, and Legal Issues – desalination and reuse
- Salinity Management – technical and institutional issues
- Source Water Augmentation for Potable Use
- Sustainability through Reuse and Desalination
- Treatment Technologies – desalination and reuse
- Urban Reuse – golf courses, parks, landscape, residential
- Water Quality Issues

Past Exhibitors and Sponsors

- Acciona Agua Corporation
- Advanced Concepts & Technologies International
- Alan Plummer Associates
- AECOM
- American Water Works Association
- APSCO
- AquaTec
- Aqua-Aerobic Systems
- Aquionics
- Ashbrook Simon-Hartley
- Basin Water
- Bio-Microbics
- Black & Veatch
- Brown and Caldwell
- Bureau of Reclamation
- Calgon Carbon Corporation
- Carollo Engineers
- CDM
- CH2M HILL
- Cheatham & Associates
- Chiang, Patel & Yerby
- Columbia Analytical Services
- Columbian TecTank
- Damon S. Williams Associates
- Degremont Technologies
- Doosan Hydro Technology
- Enviroquip, a Division of Eimco Water Technologies
- Espey Consultants
- Freese and Nichols
- Fugro Consultants
- GE Water and Process Technologies
- Geoflow
- Golder Associates
- Gorrondona & Associates
- GSWW Engineers
- Gupta & Associates
- Half Associates
- Hanna Instruments
- Hazen and Sawyer
- HDR Engineering
- ITT-Water & Wastewater
- Jacobs Carter Burgess
- Jaster-Quintanilla
- JMAR Technologies
- Kellogg Brown & Root
- Kennedy/Jenks Consultants
- King County
- Koch Membrane Systems
- Krüger
- Malcolm Pirnie
- McCall, Parkhurst & Horton
- MWH Global
- Nova Water Technologies
- Parkson
- PHOENIX Process Equipment Co.
- PolyPipe
- Pumps and Controls
- Purifics
- Schrickel, Rollins and Associates
- Severn Trent Services
- Siemens Water Technologies
- Skillings Connolly
- SolarBee
- TechRadium
- Texas Aquastore
- TrojanUV
- Underground Solutions
- Water & Waste Digest
- Water Environment Federation
- Woongjin Chemical America
- World Water Works



Schedule of Events

Sunday, September 12

| | |
|---------------------------|--|
| 9:00 am – 5:30 pm | Registration Open |
| 12:00 pm – 4:00 pm | Exhibitor Set-Up |
| 1:00 pm – 4:00 pm | Pre-Conference Workshops |
| 4:00 pm – 5:00 pm | WaterReuse Association State Section Meetings |
| 5:30 pm – 7:00 pm | Exhibit Hall Open |
| 5:30 pm – 7:00 pm | Welcome Reception in the Exhibit Hall |

Monday, September 13

| | |
|----------------------------|--|
| 7:00 am – 3:30 pm | Registration Open |
| 7:00 am – 12:00 pm | Exhibit Hall Open |
| 7:00 am – 8:00 am | Continental Breakfast in the Exhibit Hall |
| 8:00 am – 9:30 am | Opening Session |
| 9:30 am – 12:00 pm | Concurrent Technical Sessions |
| 10:30 am – 11:00 am | Refreshment Break in the Exhibit Hall |
| 12:00 pm – 1:30 pm | Awards Luncheon and Annual Membership Meeting |
| 1:30 pm – 3:30 pm | Exhibit Hall Open |
| 1:30 pm – 5:00 pm | Concurrent Sessions |
| 3:00 pm – 3:30 pm | Refreshment Break in the Exhibit Hall |
| 5:30 pm – 7:00 pm | President's Reception |

Tuesday, September 14

| | |
|----------------------------|---|
| 7:00 am – 2:00 pm | Registration Open |
| 7:00 am – 3:00 pm | Exhibit Hall Open |
| 7:00 am – 8:30 am | Continental Breakfast in the Exhibit Hall |
| 7:30 am – 8:30 am | Early Bird Sessions |
| 8:30 am – 10:00 am | International Legislative and Water Policy Plenary Session |
| 10:00 am – 10:30 am | Refreshment Break in the Exhibit Hall |
| 10:30 am – 12:00 pm | Concurrent Sessions |
| 12:00 pm – 1:00 pm | Lunch on Your Own |
| 12:00 pm – 1:00 pm | WaterReuse Association Committee Meetings |
| 1:00 pm – 5:00 pm | Concurrent Sessions |
| 2:30 pm – 3:00 pm | Refreshment Break in the Exhibit Hall |
| 3:00 pm – 7:00 pm | Exhibitor Tear-Down |

Wednesday, September 15

| | |
|----------------------------|------------------------------|
| 6:30 am – 8:30 am | Registration Open |
| 6:30 am – 8:00 am | Continental Breakfast |
| 7:00 am – 8:00 am | Early Bird Sessions |
| 8:00 am – 10:00 am | Concurrent Sessions |
| 10:00 am – 12:00 pm | Closing Plenary Session |
| 12:00 pm – 12:15 pm | Executive Director's Closing |

Exhibit Hall Floor Plan

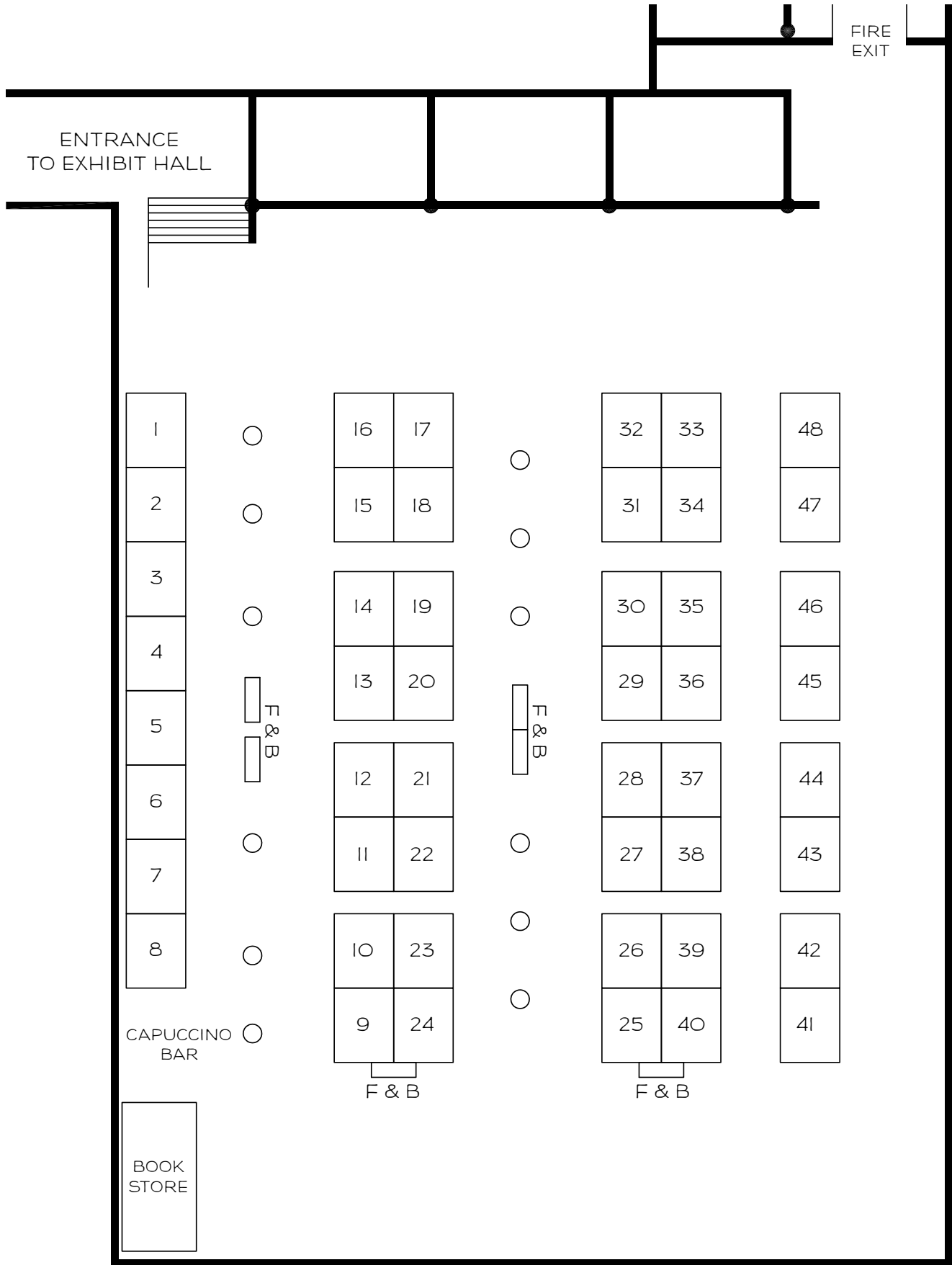

Exhibit Opportunities

A booth placed strategically in the Exhibit Hall will put your organization at the center of all the action. The WaterReuse Association recognizes that exhibits are an integral component to the success of the 25th Annual WaterReuse Symposium. The Exhibit Hall is designed to maximize face-to-face communication between exhibitors and attendees. In addition to posted hours, the following traffic-boosting events will be held in the Exhibit Hall:

- Welcome Reception
- Continental Breakfasts
- Refreshment Breaks
- Passport to the Exhibits Contest

Exhibit Booth Fees

| | Before June 28 | After June 28 |
|----------------|----------------|---------------|
| Member Rate | \$1,700 | \$1,950 |
| Nonmember Rate | \$2,200 | \$2,450 |

Exhibit Booth Includes:

- 8' x 10' Booth with Pipe and Drape, Header Sign and Carpeting
- One Complimentary Full Meeting Registration
- Two Exhibit Hall Only Passes for Additional Staff
- Attendee Mailing Address List (pre and post)
- Company Information on the Website and in the Onsite Program Book
- One Copy of the Symposium Proceedings on a Flash Drive

The Exhibit Booth does not include a six-foot table or chairs; these are additional and will need to be ordered directly through GES.

Shipping, electricity, telephone/internet lines, furnishing, labor, etc. are also additional.

The complimentary full meeting registration includes admission to sessions, breakfasts, lunch and receptions. Additional staff must register separately to attend the entire conference; however, up to two exhibit hall only badges are available for booth personnel. Discounted meal tickets can be purchased for exhibit hall only staff that would like to participate in functions outside of the exhibit hall.

Set-Up and Tear-Down Hours

| | |
|-----------------------|--------------------|
| Set-Up | |
| Sunday, September 12 | 12:00 pm – 4:00 pm |
| Tear-Down | |
| Tuesday, September 14 | 3:00 pm - 7:00 pm |

Exhibit Hall Hours

The Exhibit Hall is tentatively scheduled to be open during the following hours:

| | |
|------------------------------|---|
| Sunday, September 12 | 5:30 pm – 7:00 pm |
| Monday, September 13 | 7:00 am – 12:00 pm 1:30 pm – 3:30 pm |
| Tuesday, September 14 | 7:00 am – 3:00 pm |

Contractor Services

GES will be the official decorating company of the 25th Annual WaterReuse Symposium. GES will provide a website that allows exhibitors to have 24/7 access to show information, place orders for products and services, and retrieve important information. Forms for ordering services such as: carpet, booth furnishings, labor for installing and dismantling, signs, vacuuming, electrical outlets, telephones, material handling, audio visual, porter service, and florist arrangements will be available on the GES website. GES will be your main contact for shipping and storing of exhibit materials, instructions and forms, booth furniture rental, labor, and other booth services needed.

Memory Scanner Lead Retrieval System

The Memory Scanner Lead Retrieval System is the perfect way to capture leads. This small, portable scanner makes it easy to capture vital information on each attendee. Using the scanner, you can capture the attendee's unique barcode on their badge in seconds, eliminating the post conference entry of paper leads.

Reserve your scanner now on the Exhibitor Application!

Space Assignments and Deadlines

Applications for exhibit space at the 25th Annual WaterReuse Symposium must be received no later than Monday, August 9, 2010. All exhibit applications must be accompanied by full payment of exhibit fees. All booths are assigned on a first-come, first-served basis.

Cancellations

Cancellation of exhibit space must be made in writing to the WaterReuse Association office. Refunds will be issued according to the following schedule and will be based upon either the postmark date of the letter or the date your written cancellation is received by fax at the WaterReuse Association office.

Cancellations Received On or Before August 9
50% Refund

Cancellations Received After August 9
No Refunds will be issued

Sponsorship Opportunities

For even greater visibility at the 25th Annual WaterReuse Symposium, take advantage of the sponsorship opportunities listed below. Sponsorships put your organization's name in front of influential senior managers and decision makers. These high-profile sponsorships are designed to maximize your marketing efforts at the 25th Annual WaterReuse Symposium and help your organization gain important visibility among the professionals whose focus is on the development of water reuse and desalination projects.

Platinum Conference Sponsor **\$7,500**

Platinum Conference Sponsorship Includes:

- Complimentary 8' x 10' Exhibit Booth
- Three Complimentary Full Meeting Registrations
- Full Page, Four-Color Advertisement in the Onsite Program Book
- Signage Recognition at the Symposium
- Attendee Mailing Address List (pre and post)
- Company Information on the Website and in the Onsite Program Book

Opportunity to Sponsor One of the Following:

Eco-Friendly Conference Bags

Every registered attendee will receive a conference bag. Your company logo will appear on the front of the bag and the WaterReuse, AWWA and WEF logos will appear on the back. The conference bags are a walking advertisement for your company during the conference and used throughout the year by the attendees.

Conference Proceedings on a Flash Drive

Every registered attendee will receive the conference proceedings on a flash drive. Your company logo will appear on one side of the flash drive with the WaterReuse logo on the other. You will have the opportunity to place your company information on the flash drive which will then be used by attendees at the conference and for years to come.

Eco-Friendly Badge Holders

Your company logo will be printed on the badge holders given to each attendee to wear throughout the conference.

Hotel Room Keys

Be the last thing people see as they go back to their rooms at night. Your company name and logo will appear on the hotel room keys given to all attendees that check in and stay at the Omni Shoreham Hotel.

Gold Conference Sponsor **\$5,000**

Gold Conference Sponsorship Includes:

- Two Complimentary Full Meeting Registrations
- Half Page, Four-Color Advertisement in the Onsite Program Book
- Signage Recognition at the Symposium
- Attendee Mailing Address List (pre and post)
- Company Information on the Website and in the Onsite Program Book

Opportunity to Sponsor One of the Following:

Eco-Friendly Notepads

Every registered attendee will receive a notepad. The notepad will include your company logo and website. Keep your company name in front of targeted attendees at the conference and back at the office for weeks to come.

Washington, DC Pop-Out Maps

Every registered attendee will receive a pocket sized pop-out map of Washington, DC to guide them around the city while in town for the Symposium. The pop-out map will include your company logo on the front and attendees will continuously view your logo while enjoying our nation's Capitol.

Cappuccino Bar

The Cappuccino Bar was a huge hit last year and will be placed inside the Exhibit Hall next to the Conference Bookstore and Lounge. Your company logo will be displayed on all cappuccino cups handed out to the attendees as they enjoy a freshly made cappuccino compliments of your company.

Computer Kiosk Station (2 Sponsorships Available)

All conference attendees will be able to check e-mail and surf the Web using kiosks made possible by your sponsorship. Sponsorship will include two computer kiosks placed strategically inside the Exhibit Hall and the conference registration area. Your logo will be prominently displayed on each kiosk, and your company website will be displayed as the homepage. Every time an attendee checks their e-mail, your company will be the first thing they see!

Conference T-Shirts

All conference attendees will receive a T-shirt at registration with your company logo printed on the front and the conference design on the back. The T-shirt sponsor will have the benefit of being permanently associated with 25th Annual WaterReuse Symposium, as many attendees wear their conference T-shirts at work as well as at future WaterReuse conferences.

Welcome Reception

Be the first to welcome the attendees to Washington, DC and the 25th Annual Symposium by sponsoring the Welcome Reception in the Exhibit Hall on Sunday evening. Your company logo will be displayed on all food and beverage napkins.

President's Reception

The President's Reception will take place on the Omni Shoreham's lawn nestled on 11 acres in picturesque Rock Creek Park. With incredible views, excellent food, and great networking amongst friends and colleagues, your company can sponsor a reception to remember. Your company logo will be displayed on all food and beverage napkins.

Silver Conference Sponsor \$3,000

Silver Conference Sponsorship Includes:

- One Complimentary Full Meeting Registration
- Signage Recognition at the Symposium
- Attendee Mailing Address List (pre and post)
- Company Information on the Website and in the Onsite Program Book

Opportunity to Sponsor One of the Following:

Eco-Friendly Registration Envelopes

Be the first thing attendees see, right from the moment they check in or register onsite. Your logo goes on their registration packet envelope which will be carried around throughout the conference.

Eco-Friendly Pens

Your company logo will be printed on eco-friendly pens given to each attendee at the conference.

Eco-Friendly Water Bottles

Your company logo will be printed on eco-friendly water bottles given to each attendee at the conference.

Recycling Bins

Connect your company name with corporate and environmental responsibility when you sponsor the recycling bins at 25th Annual WaterReuse Symposium. Sturdy, white cardboard recycling bins with your company logo will be placed throughout the Symposium and the Exhibit Hall area to provide practical and conscientious benefits to all Symposium participants.

Conference Bookstore & Lounge

The Conference Bookstore will offer WaterReuse Foundation research reports and publications of the WaterReuse Association, as well as books published by conference speakers. Your company logo will be printed on the bags given out to every attendee who makes a purchase and you will have the opportunity to display literature at the lounge.

Bronze Conference Sponsor \$1,000

Recognition as a General Conference Sponsor

Bronze Conference Sponsorship Includes:

- Signage Recognition at the Symposium
- Attendee Mailing Address List (pre and post)
- Company Information on the Website and in the Onsite Program Book

Application Deadline

Applications for sponsorship at the 25th Annual WaterReuse Symposium must be received no later than Monday, August 9, 2010. All sponsorship applications must be accompanied by full payment of fees.

Cancellations

Cancellation of sponsorship must be made in writing to the WaterReuse Association office. Refunds will be issued according to the following schedule and will be based upon either the postmark date of the letter or the date your written cancellation is received by fax at the WaterReuse Association office.

Cancellations Received On or Before August 9

50% Refund

Cancellations Received After August 9

No Refunds will be issued

Exhibitor Application

Exhibitor Information

The contact information listed here will be included in the onsite program book.

Company _____

Company Contact (listed in the program) _____

Title _____

Address _____

City, State/Province, Zip _____

Phone _____ Fax _____

E-Mail _____

Show Contact (for show logistics) _____ Phone _____

E-Mail _____

Complimentary Meeting Registration Designee

Every exhibitor will receive one complimentary meeting registration. If the complimentary meeting registration will be given to someone other than the company contact listed above, please fill in the appropriate information below:

Name _____

Title _____

Address _____

City, State/Province, Zip _____

Phone _____ Fax _____

E-Mail _____

Exhibit Hall Only Staff (Limit of 2)

Name _____ E-Mail _____

Name _____ E-Mail _____

Booth Location Request

Space will be reserved on a first-come, first-served basis. Indicate below your first, second, and third choice booth locations.

1) _____ 2) _____ 3) _____

Exhibit Booth Fees

| | Before June 28 | After June 28 |
|---|----------------|---------------|
| <input type="checkbox"/> Member Rate | \$1,700 | \$1,950 |
| <input type="checkbox"/> Nonmember Rate | \$2,200 | \$2,450 |

Memory Scanner Lead Retrieval System

Memory Scanner \$250

Discount Meal Tickets (Limit of 2 Additional Staff)

Each exhibiting company receives one complimentary meeting registration which includes all meals. Up to two additional exhibiting staff can purchase meal tickets for the Awards Luncheon and President's Reception on Monday as well as the Gordon Cologne Breakfast on Wednesday. The Sunday night reception is included for all exhibitors as well as breakfast and refreshment breaks on Monday and Tuesday. Please check the appropriate box below for any additional meal tickets your company will need:

- Monday's Awards Luncheon Only \$30
 Monday's President's Reception Only \$35

Staff Receiving Meal Ticket _____

Staff Receiving Meal Ticket _____

Payment

Full payment must accompany application.

Check Visa MasterCard American Express

Total Amount to be Charged: \$ _____

Credit Card # _____ Expiration Date _____

Cardholder Name _____

Signature _____ Date _____

Please return this form with payment to:

WaterReuse Association
1199 North Fairfax Street, Suite 410
Alexandria, VA 22314
Fax: (703) 548-5085

Sponsorship Application

Sponsor Information

The contact information listed here will be included in the onsite program book.

Company _____

Company Contact (listed in the program) _____

Title _____

Address _____

City, State/Province, Zip _____

Phone _____ Fax _____

E-Mail _____

Show Contact (for show logistics) _____ Phone _____

E-Mail _____

Meeting Attendee Designee(s)

Based on the type of sponsorship you choose, please complete the information for your complimentary meeting registration(s).

Name _____ Phone _____

E-Mail _____

Name _____ Phone _____

E-Mail _____

Name _____ Phone _____

E-Mail _____

Please return this form with payment to:

WaterReuse Association
1199 North Fairfax Street, Suite 410
Alexandria, VA 22314
Fax: (703) 548-5085

Sponsorship Rates

Platinum Package

\$7,500

Exhibit Booth Location Request:

1) _____ 2) _____ 3) _____

- Eco-Friendly Conference Bags
- Conference Proceedings on a Flash Drive
- Eco-Friendly Badge Holders
- Hotel Room Keys

Gold Package

\$5,000

- Eco-Friendly Notepads
- Washington, DC Pop-Out Map
- Cappuccino Bar
- Computer Kiosk Station (2 Sponsorships Available)
- Conference T-Shirts
- Welcome Reception
- President's Reception

Silver Package

\$3,000

- Eco-Friendly Registration Envelopes
- Eco-Friendly Pens
- Eco-Friendly Water Bottles
- Recycling Bins
- Conference Bookstore & Lounge

Bronze Package

\$1,000

- Recognition as a General Conference Sponsor

Payment

Full payment must accompany application.

- Check
- Visa
- MasterCard
- American Express

Total Amount to be Charged: \$ _____

Credit Card # _____ Expiration Date _____

Cardholder Name _____

Signature _____ Date _____

Travel and Transportation Information

Hotel Information

The 25th Annual WaterReuse Symposium will be held at the Omni Shoreham Hotel. Special rates have been secured for conference attendees at the hotel. Please refer to the 25th Annual WaterReuse Symposium when making reservations in order to obtain the conference rate. We have a limited block of rooms at the hotel; therefore, all rooms are on a first-come, first-served basis. All reservations must be made by **Saturday, August 21, 2010** in order to ensure the special conference room rate.

Omni Shoreham Hotel

2500 Calvert Street, NW
Washington, DC 20008
(202) 234-0700

Room Rate: \$219 per night plus tax

Transportation Information

The Omni Shoreham Hotel is conveniently located close to the three major metropolitan airports and just one block from the Woodley Park Metro stop.

Ronald Reagan Washington National Airport (DCA)

7 miles

Washington Dulles International Airport (IAD)

30 miles

Baltimore-Washington International Airport (BWI)

35 miles

Car Rental

The WaterReuse Association and Enterprise Rent-A-Car have partnered to provide discounted car rental rates for the 25th Annual WaterReuse Symposium. The discounted rates include 10% off all airport rentals with no underage fees and no additional driver fees.

Reservations can be made two ways:

- Visit www.enterprise.com and enter in the promotional/account code of **16SW201**. When prompted for a pin, enter **wat**.
- Call 1-800-Rent-A-Car and give them our promotional/account code of **16SW201**.

Parking

The Omni Shoreham Hotel offers ample parking at a rate of \$28 per day.

Dates to Remember

| | |
|---------------------|---|
| June 28 | Last Date to Receive Discounted Exhibit Rates |
| August 9 | Application Deadline for Exhibitors and Sponsors |
| August 9 | Cancellation Deadline for Exhibitors and Sponsors |
| August 21 | Hotel Reservation Deadline |
| September 12 | Exhibitor Set-up: 12:00 pm – 4:00 pm |
| September 14 | Exhibitor Tear-down: 3:00 pm – 7:00 pm |

Contact Information

WaterReuse Association

Courtney Tharpe
Director of Conferences and Events
1199 N. Fairfax Street
Suite 410
Alexandria, VA 22314

Phone (703) 548-0880 ext. 101

Fax (703) 548-5085

ctharpe@watereuse.org

www.watereuse.org

Upcoming Events

Water Reuse and Desalination: Water Scarcity Solutions for the 21st Century

Sydney, Australia
November 15-17, 2010

2011 WaterReuse California Annual Conference

Laguna Cliffs Resort & Spa
Dana Point, CA
March 6-8, 2011

15th Annual Water Reuse & Desalination Research Conference

South Point Hotel and Casino
Las Vegas, NV
May 16-17, 2011

26th Annual WaterReuse Symposium

Sheraton Wild Horse Pass Resort
Phoenix, AZ
September 11-14, 2011



1199 North Fairfax Street, Suite 410
Alexandria, VA 22314

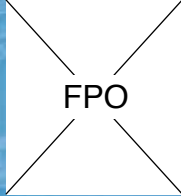

Omni Shoreham Hotel • September 12-15, 2010